

Technical thermometer, TR (straight style) and TU (angled style)

Product features

- Installation in any orientation
- The thermometer dial head can work in any environment, from -30°C to +110°C
- Made of stainless steel, grade 17
- Protective glass cover on the dial scale

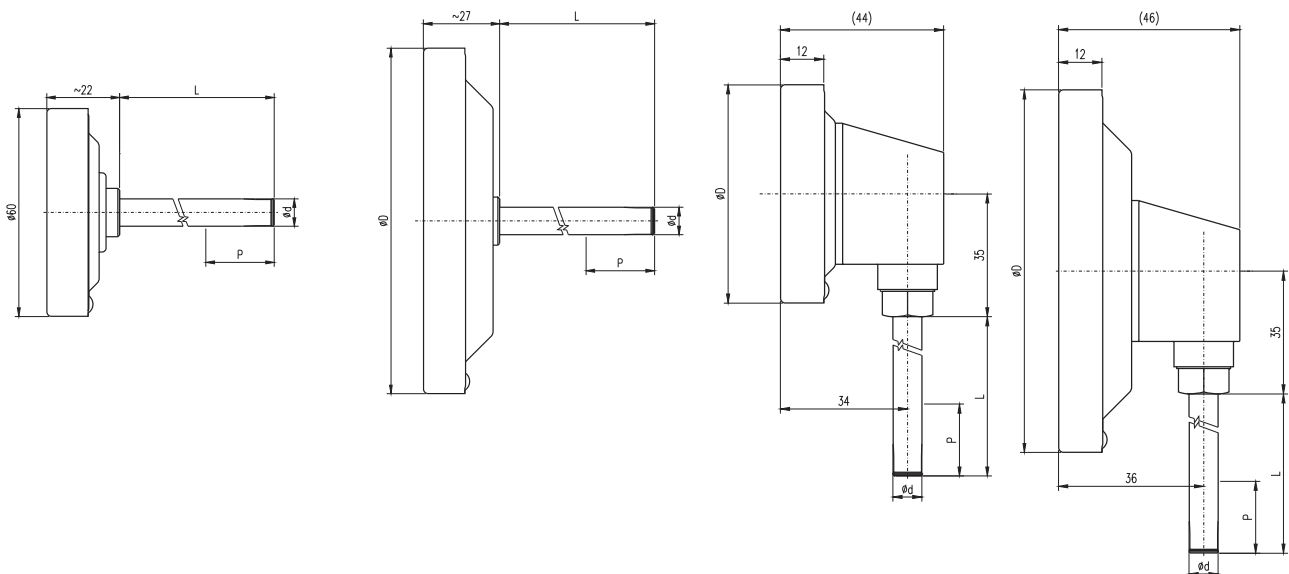

Specifications

Type	Head diameter	Graduation	Scale range	Measurement range	Stem length									
					d = 8 mm (AKVS stainless steel)					d = 10 mm (grade 11 or AKVS) x* – AKVS only				
					45	60	100	160	250	400	630	1000	1500	
TR 60	60	1	-30 - 50	-20 - 40			x	x	x	x				
		1	0 - 120	20 - 100	x		x	x	x	x				
		2	0 - 200	20 - 180	x		x	x	x	x				
		5	0 - 350	50 - 300				x	x	x				
		10	0 - 450	50 - 400				x	x	x				
TR 100	100	1	-30 - 50	-20 - 40			x	x	x	x	x	x	x	x
		1	0 - 120	20 - 100	x		x	x	x	x	x	x	x	x
		2	0 - 160	20 - 140			x	x	x	x	x	x	x	x
		2	0 - 200	20 - 180	x		x	x	x	x	x	x	x	x
		5	0 - 350	50 - 300				x	x	x	x	x	x	x
		10	0 - 450	50 - 400			x	x	x	x	x*	x*	x*	
TR 120	120	1	-30 - 50	-20 - 40			x	x	x	x	x	x	x	x
		1	0 - 120	20 - 100			x	x	x	x	x	x	x	x
		2	0 - 200	20 - 180			x	x	x	x	x	x	x	x
		5	0 - 350	50 - 300				x	x	x	x	x	x	x
		10	0 - 450	50 - 400				x	x	x	x	x*	x*	x*
TU 60	60	1	-30 - 50	-20 - 40				x	x	x	x			
		1	0 - 120	20 - 100				x	x	x	x			
		2	0 - 200	20 - 180				x	x	x	x			
		5	0 - 350	50 - 300				x	x	x	x			
		10	0 - 450	50 - 400				x	x	x	x			
TU 100	100	1	-30 - 50	-20 - 40				x	x	x	x	x	x	x
		1	0 - 120	20 - 100				x	x	x	x	x	x	x
		2	0 - 160	20 - 140				x	x	x	x	x	x	x
		2	0 - 200	20 - 180				x	x	x	x	x	x	x
		5	0 - 350	50 - 300				x	x	x	x	x	x	x
		10	0 - 450	50 - 400				x	x	x	x	x*	x*	x*
TU 120	120	1	-30 - 50	-20 - 40				x	x	x	x	x	x	x
		1	0 - 120	20 - 100				x	x	x	x	x	x	x
		2	0 - 200	20 - 180				x	x	x	x	x	x	x
		5	0 - 350	50 - 300				x	x	x	x	x	x	x
		10	0 - 450	50 - 400				x	x	x	x	x*	x*	x*